

1. Verify the package contents.
Compruebe el contenido del paquete.
Vérifiez le contenu de l'emballage.
Lieferumfang prüfen.
Verifica dei contenuti della confezione.

تحقق من محتويات العبوة

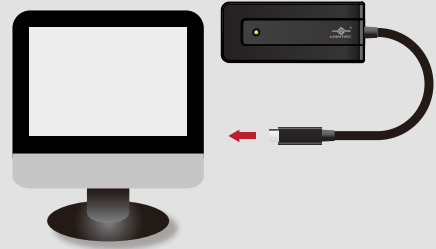

2. Plug the Vantec 4-Port USB 3.1 Bus-Powered Travel Hub (Upstream Port) into your Computer System's USB Type C port. Enchufe el concentrador portátil alimentado por bus USB 3.1 de 4 puertos de Vantec (puerto ascendente) al puerto USB Type C del sistema. Branchez le concentrateur de voyage Vantec alimenté par bus 4 ports USB 3.1 (Port ascendant) dans le port USB Type C de votre ordinateur. Stecken Sie den Vantec-4-Port-USB 3.1-Reisehub mit Bus-Stromversorgung (Upstream-Port) in den USB Type C-Port Ihres Computersystems. Inserire l'hub da viaggio alimentato da bus dotato di 4 porte USB 3.1 Vantec (porta upstream) nella porta USB Type C del computer.

وصل الموزع النقال رباعي المنافذ المستمد طاقته من واجهة توصيل USB 3.1 من شركة Vantec (منفذ الاتجاه الصاعد) بمنفذ USB Type C فائق السرعة في جهاز الكمبيوتر.



3. Upon powering up the Computer System, the USB 3.1 Hub will be recognized by the Computer System's Operating System and ready for use. Al encender el sistema, el concentrador USB 3.1 será reconocido por el sistema operativo y estará listo para utilizarse. Lors de la mise sous tension de l'ordinateur, le concentrateur USB 3.1 est reconnu par le système d'exploitation de l'ordinateur. Il est prêt à l'emploi. Beim Einschalten des Computersystems wird der USB 3.1-Hub vom Betriebssystem des Computers erkannt und ist einsatzbereit. Dopo l'accensione del sistema, l'hub USB 3.1 verrà riconosciuto dal sistema operativo del computer e sarà pronto per l'uso.

بعد تشغيل جهاز الكمبيوتر، سيتعرف نظام التشغيل على موزع USB 3.1 وسيصبح جاهزًا للاستخدام.

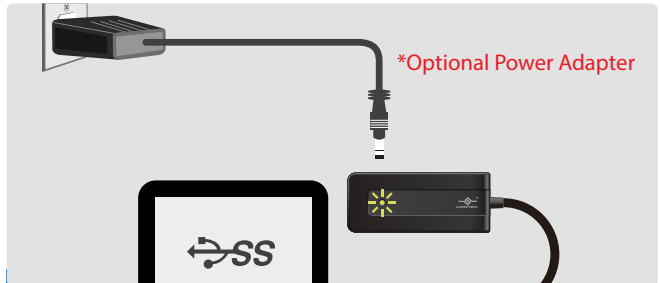

4. Optional Power adapter for UGT-MH410U3-C is using +5VDC, 2A or higher, center pin positive, Outer Dia 5.5mm. El adaptador de alimentación opcional para UGT-MH410U3-C utiliza +5 VCC y 2 A o superior, contacto central positivo y tiene un diámetro exterior de 5,5 mm. L'adaptateur secteur optionnel pour UGT-MH410U3-C utilise +5 V CC, 2 A ou supérieur, broche centrale positive, diamètre extérieur 5,5 mm. Optionales Netzteil für UGT-MH410U3-C nutzt +5 V Gleichspannung, 2 A oder mehr, mittlerer Kontakt positiv, Außendurchmesser 5,5 mm. Adattatore di corrente opzionale per UGT-MH410U3-C usa +5VDC, 2A o superiore, pin centrale positivo, diametro esterno 5,5mm.

يتم استخدام مهبط طاقة اختياري لـ UGT-MH410U3-C بقدرة +5 فولت تيار مستمر و2 أمبير أو أعلى، بسن مركزي موجب وقطر خارجي 5.5 مم.

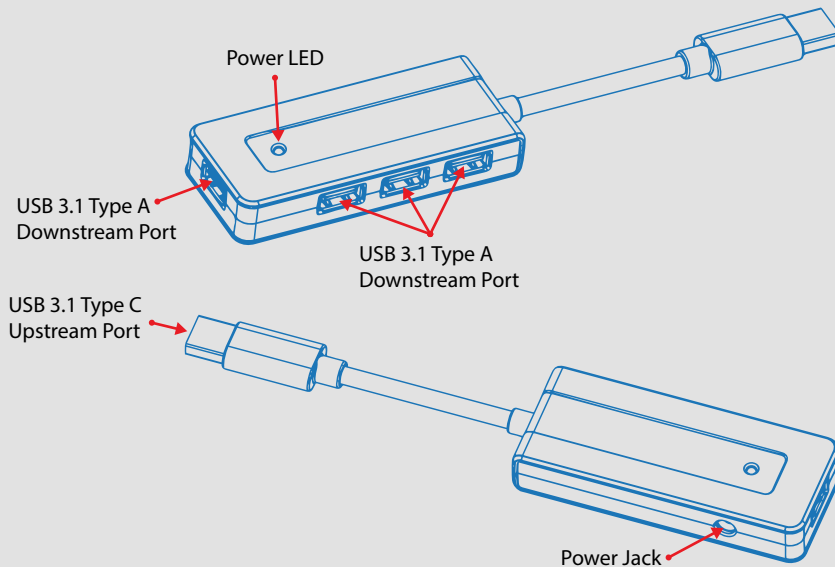

Optional Ac Adapter

Input: 100-240V - 50/60Hz
0.30A MAX
Output: 5.0VDC, 2A

Product Introduction:

The Vantec 4-Port USB 3.1 Gen 1 5Gbps Type C Bus-Powered Travel Hub makes a perfect companion with laptop using USB Type C interface. It connects with the latest USB Type C and offers compatibility connection to all your USB 3.1 Gen 1, 5Gbps Type A devices and opens up the opportunity to connect multiple devices simultaneously while traveling with your laptop. This Hub is simple and light weight to go with your portable devices. With USAP support and Plug and Play design, this Hub will simplify and speed up any file transfer anywhere you go.

Features:

- Provide USB 3.1 Gen 1 5Gbps Type C Upstream Port and four USB 3.1 Gen 1 5Gbps Type A ports
- Compliant with USB 3.1 Gen 1 Specifications
- Support Simultaneous operation of multiple USB 3.0, USB 2.0 and USB 1.1 devices
- Up to 5Gbps data transfer rate
- Hot-swapping features allows you to connect/disconnect devices without powering down the system
- No Drivers needed, Plug and Play
- Support UASP Devices
- Support Windows XP,7,8,8.1,10 / Mac OS X 10.6 or Greater / Latest Linux kernel

Specification:

Model :	UGT-MH410U3-C
Device Support :	USB Type A
Upstream Ports :	1, USB 3.1 Gen 1 5Gbps Type C port
Downstream Ports :	4, USB 3.1 Gen 1 5Gbps Type A ports
Power :	Bus powered or Optional power port for AC adapter
Dimension :	287 x 38 x 17 mm

System Requirements:

- Microsoft Windows XP, 7, 8, 8.1, 10 / Mac OS X 10.6 or Greater / Latest Linux OS
- USB 3.1 Type C Port