

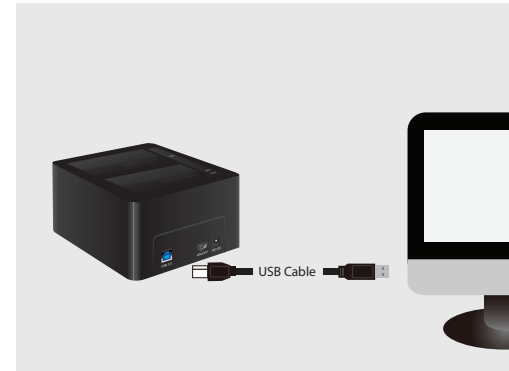

1. Verify the package contents.



2. Connect the power adapter to the NexStar TX Hard Drive Dock.



3. Connect the USB 3.0 Cable to the NexStar TX Hard Drive Dock and attach the other end to the computer.

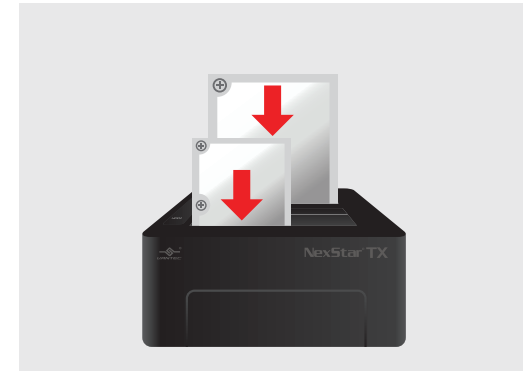

4. Insert 2.5" or 3.5" SATA Hard Drive into the slot.



5. Turn ON the power, while the system detect the Hard Drive, it's ready to use.



1. Safely remove the USB Hard Drive from the computer's operating system.



2. Once safe removal has been completed, turn OFF the power on the NexStar TX Hard Drive Dock.

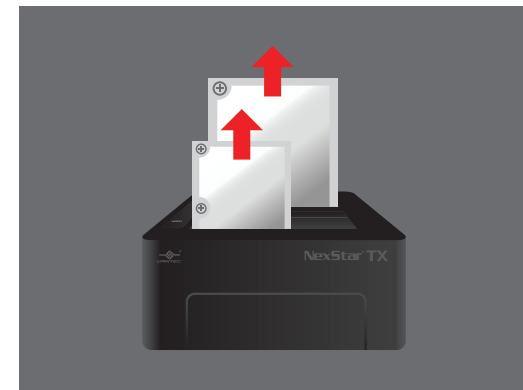

3. The Hard Drive may now be ejected and removed.

NOTE:

New hard drives needs to be initialized and partitioned before it will appear in Windows Explorer or Mac desktop.